



## Casing Heads

### Models WFT-22 and WFT-29

Casing heads in the Weatherford WFT series feature a straight bowl design with a 45° load shoulder. This preferred wellhead geometry is superior to tapered designs because of its ability to accommodate heavy hanger loads, provide precise hanger placement, and resist sticking or wedging.

The WFT-22 is designed for pressures up to 5,000 PSI and accepts WFT-21, WFT-21-P and WFT-22 casing hangers. The WFT-29 is designed for pressures up to 15,000 PSI and accepts WFT-29 casing hangers. Standard temperature ratings for both models of this cost-saving piece of equipment are -50 to +250°F.

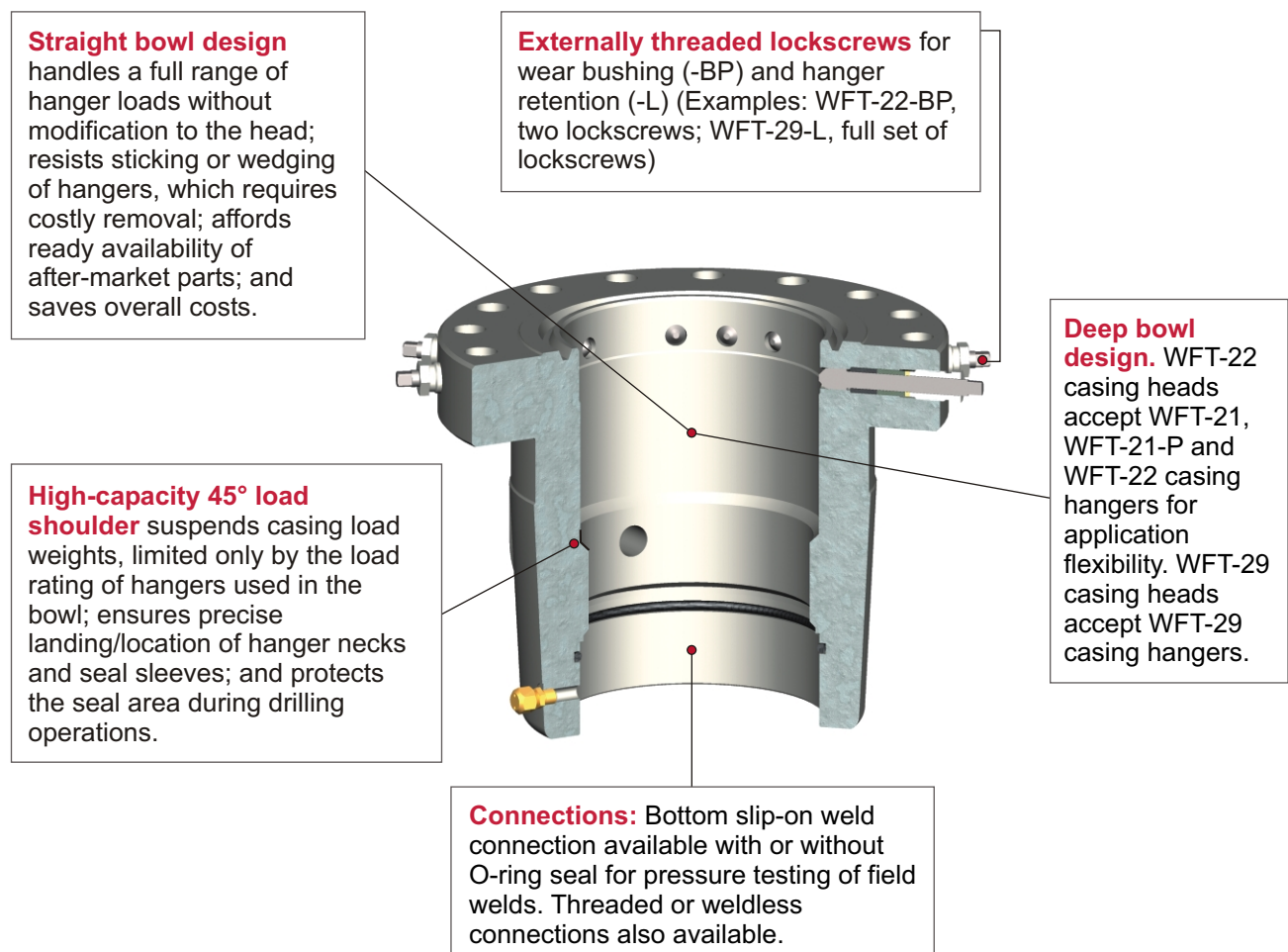



## Casing Heads

### Models WFT-22 and WFT-29

#### Advantages

- Cost-saving WFT-series casing heads offer the following advantages:
- Ability to handle a full range of hanger loads without modification to the head
  - Resistance to sticking or wedging of hangers
  - Ready availability of after-market parts
  - Precise landing/location of hanger necks and seal sleeves
  - Seal-area protection during drilling operations
  - Wear bushing and hanger retention
  - Choice of connection type
  - Choice of outlet types for flexibility to use many types of outlet equipment

#### Options

- Choice of flanged (standard) or clamp hub top connections
- Choice of threaded, studded or flanged outlets (Studded and flanged outlets require valve removal threads.)
- Landing bases and reinforcing base plates available for heavy stack loads
- WFT-22 or WFT-29 with inclusion of -L designation (Example: WFT-29-L) = full set of lockdown screws for retaining casing hanger
- WFT-22 or WFT-29 with inclusion of -BP designation (Example: WFT-22-BP) = two lockdown screws for bowl protector hold-down only

#### Specifications

Model WFT-22					
Top Flange		Casing Size (in.)	Outlet		
Nominal Size (in.)	Working Pressure (PSI)		Threaded	Studded	
			Size (in.)	Size (in.)	WP (PSI)
9	2,000	8-5/8	2	2-1/16	2,000
	3,000				5,000
11	3,000	8-5/8	2	2-1/16	5,000
		9-5/8			
	10-3/4				
	5,000				
13-5/8	3,000	11-3/4	2	2-1/16	5,000
		13-3/8			
	11-3/4				
	5,000				
16-3/4	3,000	16	2	2-1/16	3,000
21-1/4	3,000	20	2	2-1/16	5,000
		18-5/8			
	20				
	5,000	20			

Other sizes and configurations available on request.



## Casing Heads

Models WFT-22 and WFT-29

### Specifications

Model WFT-29					
Top Flange		Casing Size (in.)	Outlet		
Nominal Size (in.)	Working Pressure (PSI)		Threaded Size (in.)	Studded Size (in.)	WP (PSI)
9	2,000	8-5/8	2	2-1/16	2,000
	3,000				5,000
11	3,000	8-5/8	2	2-1/16	5,000
		9-5/8			
		10-3/4			
	5,000	8-5/8			
		9-5/8			
		10-3/4			
10,000	8-5/8				
	9-5/8				
	10-3/4				
13-5/8	3,000	11-3/4	2	2-1/16	5,000
	5,000	11-3/4			
		13-3/8			
	10,000	11-3/4			
16-3/4	2,000	16	2	2-1/16	2,000
	3,000				3,000
21-1/4	2,000	18	2	2-1/16	2,000
		20			5,000
		20			5,000
	3,000	18-5/8			
	20				
	5,000	20			

Other sizes and configurations available on request.