

Atabec Safety Lock™ for Beam Pumping Units

Adds high-performance security when servicing pumpjack units

Applications

- All beam pumping units

Features and Benefits

- Crank-arm suspension isolates and locks crank arms to prevent unwanted movement during servicing
- Safety lock actuates from outside crank guards, eliminating need for personnel to enter redzones
- Fully engineered, 3:1 suspension exceeds potential safety factors for counterweights up to 10 tons
- Secondary hydraulic-valve lockouts add ensured safety
- Chainless/binderless system prevents damage to sheave
- Simplified, closed-loop system utilizes 100% nontoxic fluid
- System adaptor retrofits to any beam pumping unit
- Safe and easy installation process

Tool Description

The Atabec safety lock is a hydraulic sheave lock which engages to safely lock/unlock the beam pumping unit. Once fully secured, the Atabec safety lock immobilizes the crank arm, even with the brake released and power turned on. The Atabec safety lock is actuated using a hydraulic pump from outside the swing area of the counterweights, dramatically reducing risk and time required to safely lock out a beam pumping unit. This patented technology improves worker safety, decreases costs, and reduces environmental impact of operations—minimizing downtime and optimizing operational maintenance, all while maximizing safety goals.

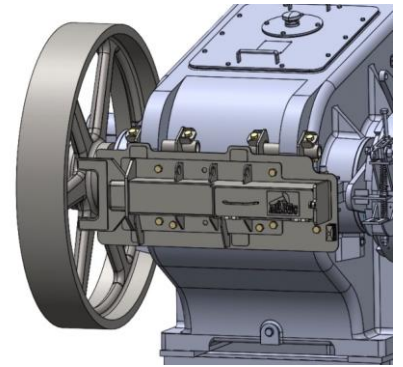

With its simple-to-operate, hand-pump hydraulic lock, the Atabec Safety Lock engages and disengages from outside the danger area. With the hydraulic fork engaged, there is zero crank movement, even with no brake and full power applied to the unit.



The Atabec safety lock helps maximize safety, minimize downtime, and optimize operational maintenance. Counterweights on beam pumping units can weigh up to 10 tons. The combined weight with momentum and pinch points creates extreme danger to employees.

